



THE COVE

Be a part of our waterfront community.

A unique opportunity for retail at The Cove in Oregon City. Sophisticated and urban design in a quaint and scenic location. Opening 1Q 2019.

Office
& Retail

4 Units Available
1,625 SF Each

1937 Main Street
Oregon City, OR 97045



GRAND PEAKS

contact@grandpeaks.com | 971-233-0300

The Cove Apartments

Located at the confluence of the Willamette and Clackamas Rivers, The Cove Apartments is a Class "A" 244-unit multifamily development. The idyllic waterfront community will offer superb common areas and waterfront access including an esplanade to the Clackamette Cove trail system and a large water-facing veranda. All retail spaces will face Main Street.

6,500 square feet
of office/retail
space available

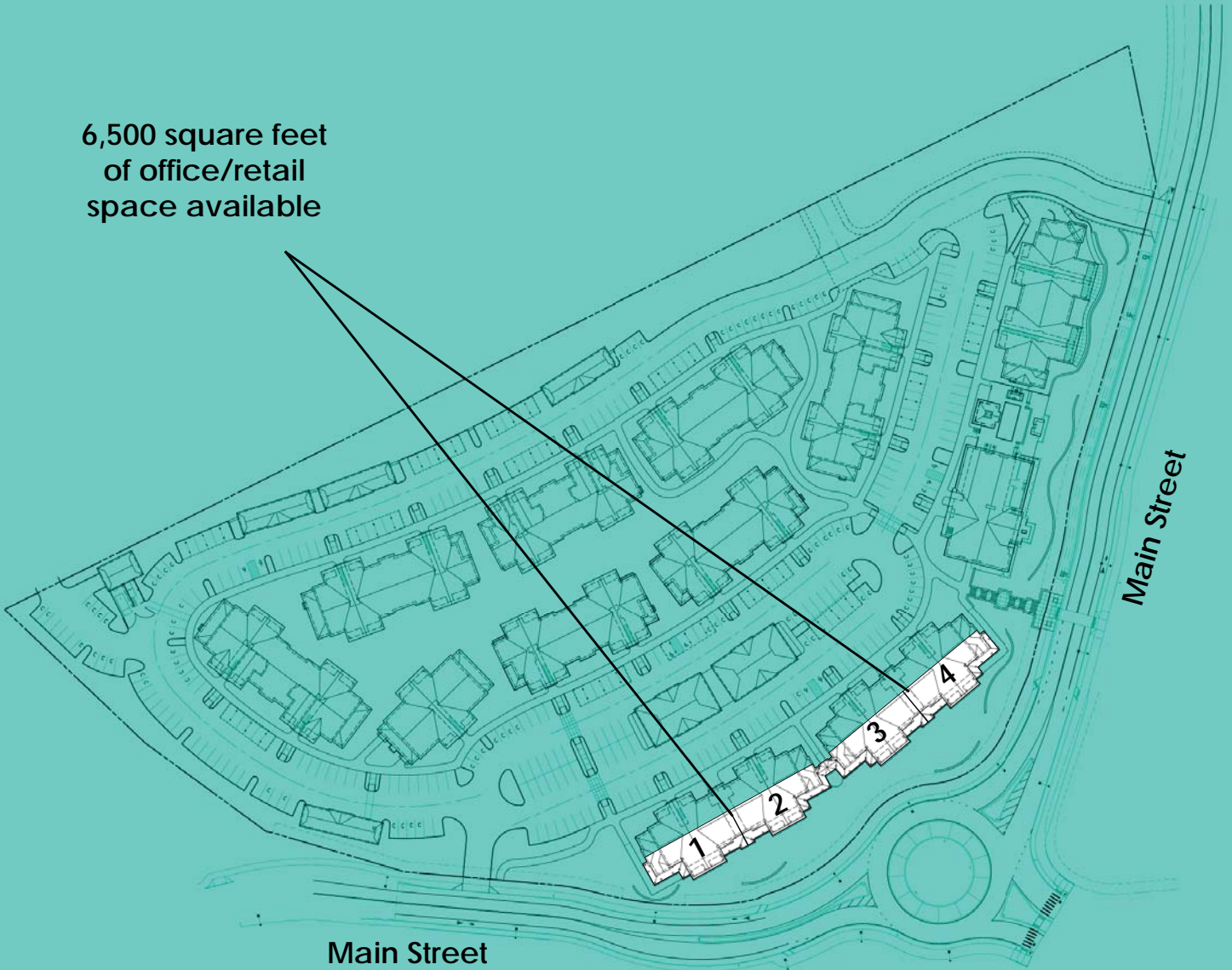

Main Street

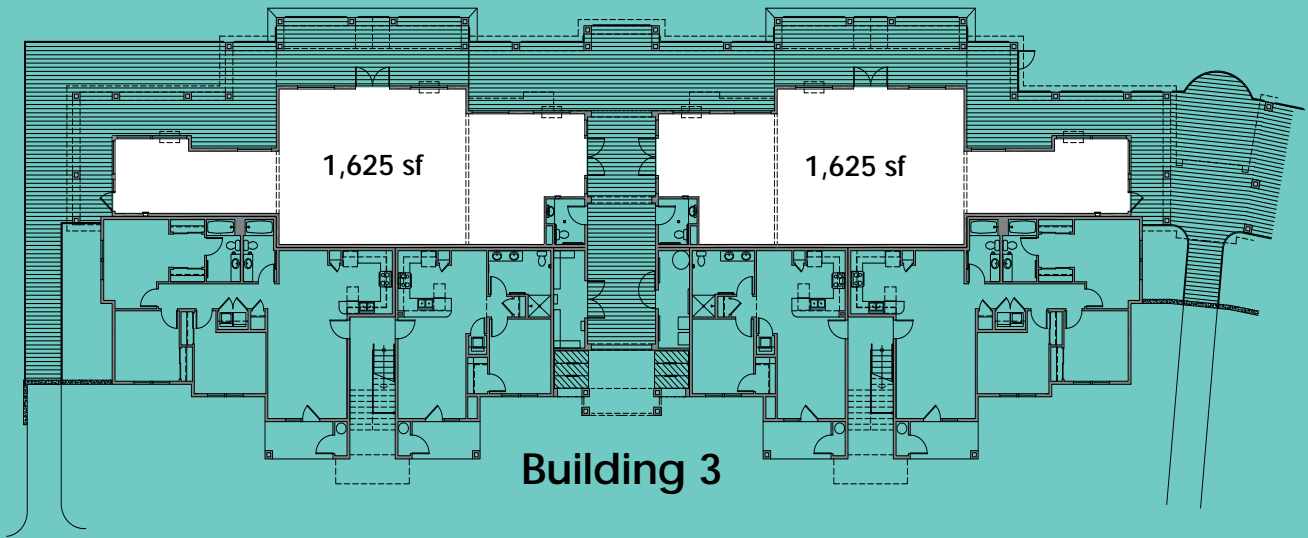

Main Street

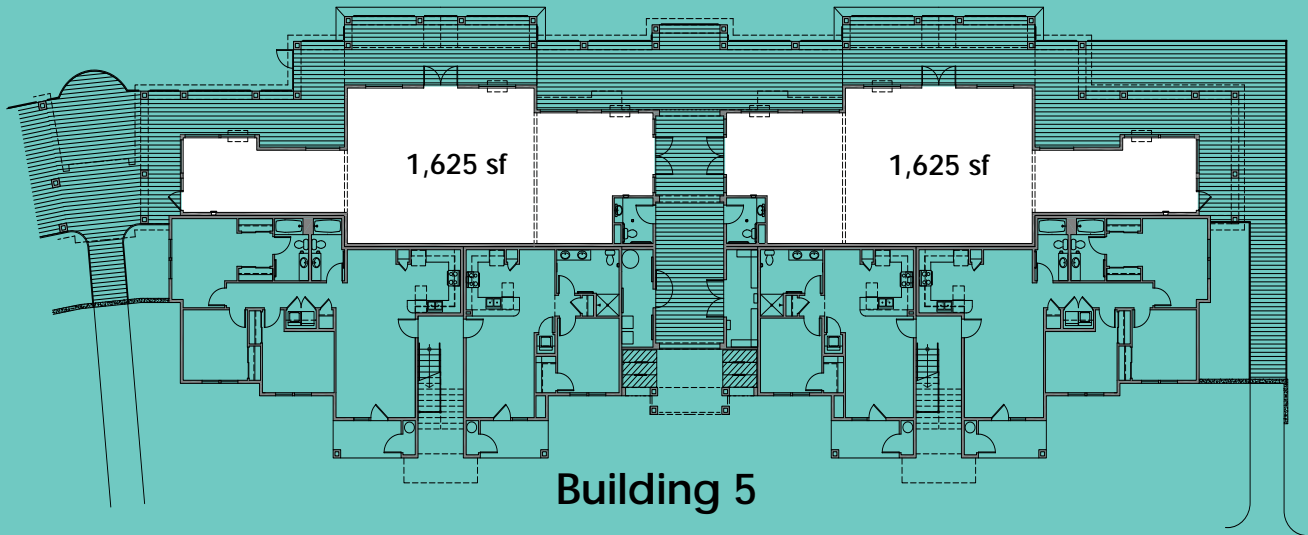

CLACKAMETTE COVE MASTER PLAN

Phase 1

Phase 2

